

# SIMCRO™

## TOPICAL APPLICATOR

30 mL DOSE LOCK FAN-SPRAY

# Elanco™

Fig 1

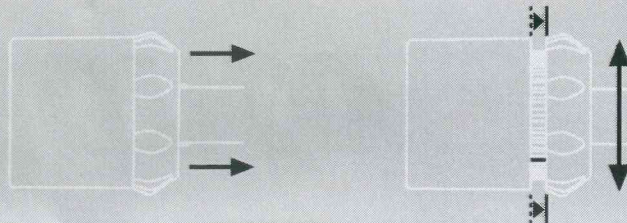
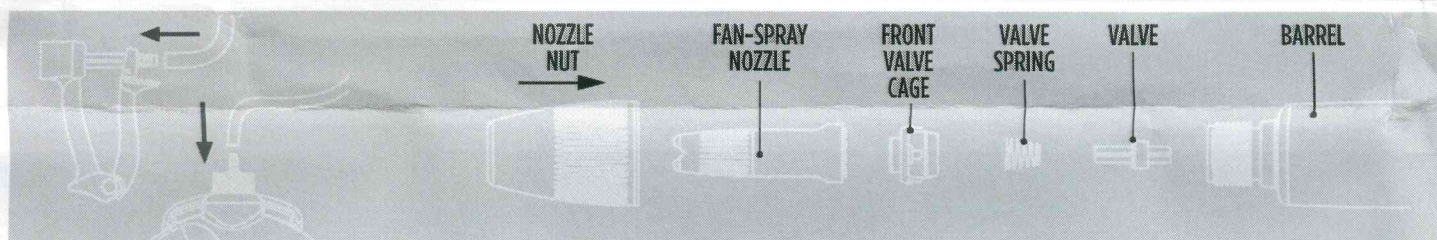
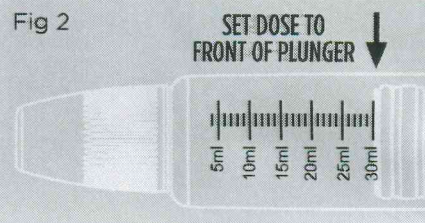

Fig 2



### To connect to backpack

- 1 Slide the two hose armour springs over each end of the delivery tube.
- 2 Push one end of the delivery tube fully onto inlet barbs on applicator (see above). Slide armour spring back over the end of delivery tube to reduce the possibility of the tube kinking.
- 3 Place pack upright and remove transit cap. Fit spigot cap to pack.
- 4 Push the other end of the delivery tube onto the spigot cap (see above). Slide armour spring over end of delivery tube.
- 5 Place backpack on back and adjust straps until comfortable.

### To set dose

- 1 Unlock dose dial by pulling it away from main body (see Fig 1).
- 2 Rotate dose dial left or right to adjust position of plunger. Align front edge of plunger with required dose setting on barrel (see Fig 2)
- 3 Push dose dial towards main body to lock selected dose.

### To prime

Operate applicator by squeezing handle until the product appears in the applicator barrel. With applicator in upward position, squeeze handle to expel all air from barrel. Care should be taken to avoid spillage of the formulation during this procedure.

### Warning:

Care must be taken to ensure the liquid does not come into contact with any part of the operators body. Chemicals may cause injury to operator.

### Maintenance

- 1 Carefully remove the delivery tube from the upright backpack and pump warm soapy water through the applicator to flush out any excess product. Then flush with clean water.
- 2 Unscrew the barrel from the handle of the applicator.
- 3 Lubricate the plunger O-ring and felt washer with either olive oil, paraffin oil or Omega 3 fish oil, by placing the front of the plunger into a tray of vegetable oil to cover the O-ring and felt washer. Leave to soak for 1 minute minimum.
- 4 Re-install the barrel after lubrication.

### Warning:

Do not over tighten barrel, light hand tightening is sufficient.

5 The only parts that can be removed are:

- 1 Nozzle
- 2 Front valve cage
- 3 Valve spring
- 4 Valve

When reassembling, place the short-fin end of the valve into the barrel, then place the narrow end of the conical spring over long-fin end of the valve. Replace the front valve cage by aligning the four keys into the four slots in the front of the barrel. Finally, replace the nozzle by threading clockwise onto the barrel.

### Note:

Repeating this maintenance process after every use will extend applicator's life.

